

WIRING EXAMPLE FOR RGB CONTROLLER

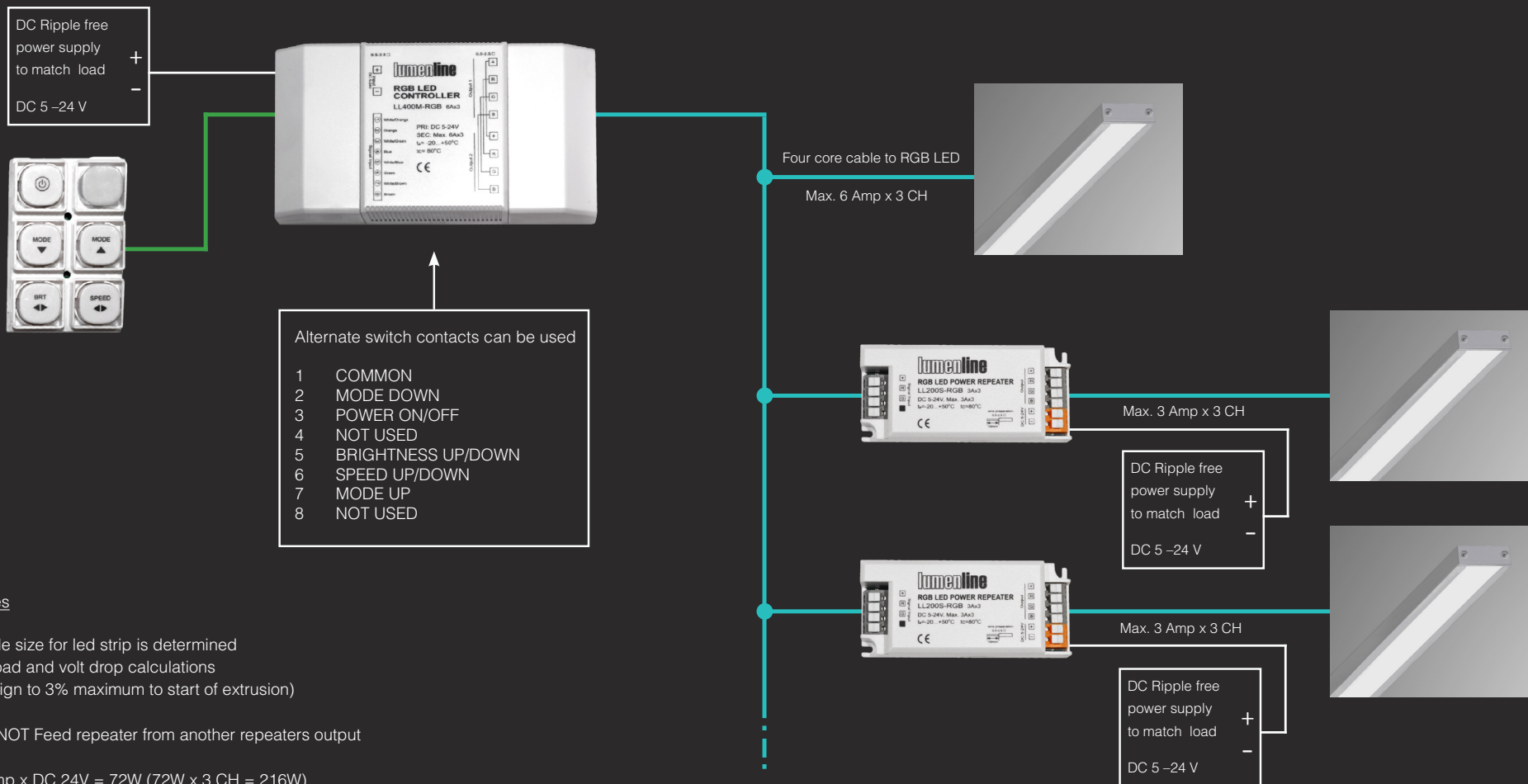

- Alternate switch contacts can be used
- 1 COMMON
 - 2 MODE DOWN
 - 3 POWER ON/OFF
 - 4 NOT USED
 - 5 BRIGHTNESS UP/DOWN
 - 6 SPEED UP/DOWN
 - 7 MODE UP
 - 8 NOT USED

Notes

Cable size for led strip is determined by load and volt drop calculations (design to 3% maximum to start of extrusion)

DO NOT Feed repeater from another repeaters output

3 Amp x DC 24V = 72W (72W x 3 CH = 216W)
 6 Amp x DC 24V = 144W (144W x 3 CH = 432W)

RGB SIGNAL FEED TO MORE REPEATERS